

CliniLever® CP-BS Lead Safe™ Hospital Wall Mixing Set Type 51 Swivel 150 C/D

Product Code: 102.21.21.00

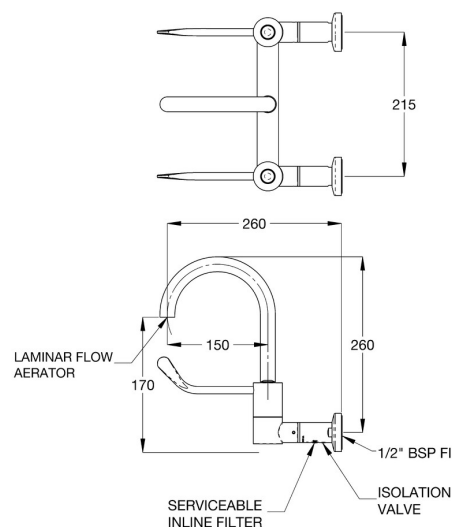

The Galvin CliniLever® Lead Free Hospital Wall Mixing Set range is supplied standard with a gooseneck outlet, laminar flow nozzle, 150mm lever handles and a bright chrome plated finish.

Features

- Components fully enclosed to avoid contaminants
- Low lying levers allow easy to use handsfree operation
- Angled spout to help minimising the risk of water becoming trapped
- Clean smooth design for easy cleaning and to help reduce dirt and bacterial growth
- Laminar flow nozzle to reduce the risk of Legionella
- High quality chrome finish for easy cleaning and hygiene maintenance
- Manufactured using Lead Free DZR Brass with less than 0.25% lead content
- Australian Made; therefore, spare parts and support are available locally, reducing maintenance and downtime costs

Technical Information

- WELS: 5 Star Rating (5.0L/min)
- Nominal Flow Rate (LPM): 4.9

- WaterMark: AS 3718 Lic. WMKA0034
- Inlet: 1/2" BSP - Female
- Outlet: Laminar Flow
- Headwork: Ceramic Disc
- Working Pressure Range (kPa): 50 Min - 500 Max
- Working Temperature Range (°C): 5 Min - 65 Max
- Construction: Lead Free DZR Brass
- Finish: Chrome

Spare Parts

- [46777](#) CliniLever® Hospital Surgical Lever Action Indicator Button Only (Blue) Cold
- [46771](#) CliniLever® Hospital Surgical Lever Action Indicator Button Only (Red) Hot
- [46783](#) CliniLever® Hospital Surgical Lever Action Indicator Button Only (Yellow) Warm

Alternative Product Options

- [102.21.11.00](#) CliniLever® CP-BS Lead Safe™ Hospital Wall Mixing Set Type 51 Swivel 150 J/V
- [102.20.11.00](#) CliniLever® CP-BS Lead Safe™ Hospital Wall Mixing Set Type 51 Fixed 150 J/V
- [102.20.21.00](#) CliniLever® CP-BS Lead Safe™ Hospital Wall Mixing Set Type 51 Fixed 150 C/D

Superseding Products

- **TC51SC1C** CliniLever® CP-BS Hospital Wall Mixing Set Type 51 Swivel 150 C/D



Environmental Sustainability

We are ISO 14001 certified and take sustainability seriously. Our products are environmentally responsible designed to be healthier for users, save water and/or energy, and minimise carbon footprint. Our target is to reduce our carbon footprint by 25%, and the use of non-recyclable/non-compostable materials across the company (e.g. plastics) by 50%.

Warranty

Galvin Engineering products are covered under our Manufacturer's Warranty. Galvin Engineering products must be installed in accordance with the installation instructions and in accordance with AS 3500 and NCC Volume Three, relevant Australian Standards and local authorities applicable to product being installed. Water and electrical supply conditions must also comply to the applicable national and/or state standards, failing to comply with these provisions may void the product warranty and affect performance of the product.

Please visit www.galvinengineering.com.au to view the full warranty, our Installation Compliance and Maintenance & Cleaning information as well as any other additional information.

While all reasonable care has been taken in compiling the information in this document, the designs, dimensions and products shown are indicative only and should not be relied upon without our prior approval. Due to our policy of continuous development, we reserve the right to alter any details of specifications or products without notice. All information, drawings, technical specifications and product designs remain the property of Galvin Engineering Pty Ltd.

Our Lead Safe™ product range is compliant with the Lead Free Requirements of the NCC 2022 Vol. Three, Clause A5G4(2) and NSF/ANSI 372.

Within Australia: **1300 514 074**
 Outside Australia: P: +61 (0)8 9338 2344
sales@galvinengineering.com.au
www.galvinengineering.com.au



A family
owned
Australian
business

